

## MorSafe™ Online Bolt Renewal Clamp (ASME 8 Bolt Flange)

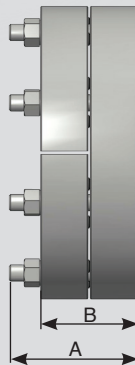
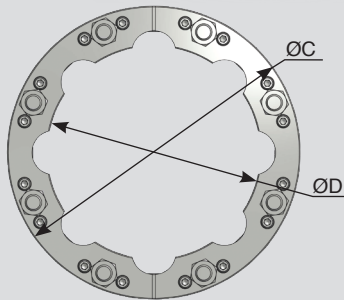
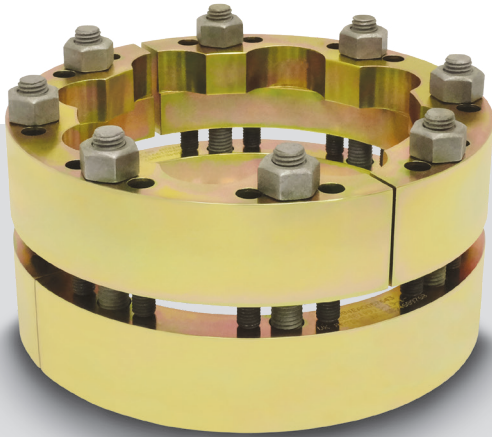

Hydratight offers Bolt Renewal Services on all ASME flanges, allowing services to be performed without any damage, leakage or interruptions in daily production.

Our service covers:

- All ASME flanges, all sizes, all pressure ratings
- All services, subjected to a risk assessment
- Piping system temperature between -46°C (-51°F) to 250°C (480°F)

Our service teams use a robust, yet simple hot bolting clamp. It does not require any pneumatics or hydraulics for clamp engagement, so it requires less bulky systems for a given flange size. The lightweight and compact design fits almost all flange space restrictions; it is easy to handle and fit, therefore enabling speedy bolt replacement.

The clamp consists of segments that are bolted around the flange, with patented backstops which prevent the clamp pre-tensioning from being transferred directly to the flange. Clamps for 8-bolted flanges have an enclosed design with space for use of a hydraulic socket wrench, spanner and twist socket.

### 8 Bolt Specifications

Assembly Number	Pipe size (inch)	Flange Class	Flange Bolt Dia.	Overall Thickness w studs (A)		O.D.		Overall Weight	
				mm	in	mm	in	kg	lbs
N0400A0150AB	4	150	5/8"	150	5.91	280	11.02	16.7	36.7
N0500A0150AB	5	150	3/4"	150	5.91	305	12.01	18.2	40.0
N0600A0150AB	6	150	3/4"	150	5.91	341	13.43	26.1	57.3
N0800A0150AB	8	150	3/4"	150	5.91	408	16.06	35.5	78.0
N0200A0300AB	2	300	5/8"	120	4.72	207	8.15	9.4	20.6
N0300A0300AB	3	300	3/4"	150	5.91	261	10.28	16.9	37.3
N0400A0300AB	4	300	3/4"	150	5.91	305	12.01	22.8	50.2
N0200A0600AB	2	600	5/8"	150	5.91	216	8.50	13.4	29.4
N0208A0600AB	2.5	600	3/4"	150	5.91	242	9.53	16.3	35.8
N0300A0600AB	3	600	3/4"	170	6.69	272	10.71	24.4	53.8
N0400A0600AB	4	600	7/8"	180	7.09	344	13.54	39.7	87.2
N0500A0600AB	5	600	7/8"	200	7.87	400	15.75	52.4	115.3
N0300A0900AB	3	900	7/8"	190	7.48	303	11.93	30.0	65.9
N0400A0900AB	4	900	1-1/8"	220	8.66	370	14.57	52.2	114.8
N0200A1500AB	2	1500	7/8"	190	7.48	278	10.94	26.9	59.1
N0300A1500AB	3	1500	1-1/8"	220	8.66	345	13.58	49.4	108.8
N0400A1500AB	4	1500	1-1/4"	240	9.45	397	15.63	70.4	154.9
N0200A2500AB	2	2500	1"	220	8.66	305	12.01	40.6	89.3
N0300A2500AB	3	2500	1-1/4"	260	10.24	391	15.39	80.6	177.3
N0400A2500AB	4	2500	1-1/2"	300	11.81	459	18.07	127.4	280.3
N0600A2500AB	6	2500	2"	400	15.75	623	24.53	304.5	669.9